

PROPOSED PLAN OF G+V STORED BUILDING PLAN OF SANKAR PRASAD DEY & OTHERS AT MOUZA - DIGLA, J.L. NO. - 18 R.S. NO. - 161, TOLUJI NO. - 173, L.R. DAG NO. - 420 & 413/441, L.R. KHATAN NO. - 3511 & 4540, HOLDING NO. - 63, P.K. GUJIA LANE, WARD NO. - 10, UNDER DUM DUM MUNICIPALITY, P.S. - DUM DUM, KOLKATA - 700 028, DIST. - 24 PUSHTI.

**AREA STATEMENTS:**

AREA OF LAND = 96.37 CH. - 33.5 FT. = 603.16 SQ.M.

PROPOSED GROUND FLOOR COVERED AREA OF BLOCK - A = 150.00 SQ.M.

PROPOSED GROUND FLOOR COVERED AREA OF BLOCK - B = 150.00 SQ.M.

PROPOSED TOTAL GROUND FLOOR COVERED AREA = 300.00 SQ.M.

PROPOSED CAR PARKING AREA OF BLOCK - A = 125.00 SQ.M.

PROPOSED CAR PARKING AREA OF BLOCK - B = 125.00 SQ.M.

PROPOSED TOTAL CAR PARKING AREA = 250.00 SQ.M.

PROPOSED TOTAL COVERED AREA OF BLOCK - A = 150.00 SQ.M.

PROPOSED TOTAL COVERED AREA OF BLOCK - B = 150.00 SQ.M.

PROPOSED TOTAL COVERED AREA OF BLOCK - A & B = 300.00 SQ.M.

PERMISSIBLE COVERED AREA = 300.00 SQ.M.

**CERTIFICATE OF OWNERS:**

I, THE UNDERSIGNED, PROPRIETOR OF THE ABOVE MENTIONED PROJECT, HEREBY CERTIFY THAT ALL THE INFORMATION AND DATA FURNISHED TO YOU BY ME ARE TRUE AND CORRECT TO THE BEST OF MY KNOWLEDGE AND BELIEF. I HEREBY AUTHORIZE YOU TO USE THE SAME FOR THE PURPOSES OF THE ABOVE MENTIONED PROJECT AND TO SIGN AND SUBMIT TO THE CONCERNED AUTHORITY THE NECESSARY DOCUMENTS FOR THE SAME. I HEREBY AUTHORIZE YOU TO SIGN AND SUBMIT TO THE CONCERNED AUTHORITY THE NECESSARY DOCUMENTS FOR THE SAME. I HEREBY AUTHORIZE YOU TO SIGN AND SUBMIT TO THE CONCERNED AUTHORITY THE NECESSARY DOCUMENTS FOR THE SAME.

**IMA MANASA CONSTRUCTION**  
Proprietor

**CERTIFICATE OF ENGINEER:**

I, THE UNDERSIGNED, CIVIL ENGINEER, HAVE EXAMINED THE ABOVE MENTIONED PROJECT AND THE NECESSARY DOCUMENTS SUBMITTED TO ME BY THE PROPRIETOR AND I HEREBY CERTIFY THAT THE SAME ARE TRUE AND CORRECT TO THE BEST OF MY KNOWLEDGE AND BELIEF. I HEREBY AUTHORIZE YOU TO USE THE SAME FOR THE PURPOSES OF THE ABOVE MENTIONED PROJECT AND TO SIGN AND SUBMIT TO THE CONCERNED AUTHORITY THE NECESSARY DOCUMENTS FOR THE SAME. I HEREBY AUTHORIZE YOU TO SIGN AND SUBMIT TO THE CONCERNED AUTHORITY THE NECESSARY DOCUMENTS FOR THE SAME.

**ASHIM KUMAR SAHA**  
Civil Engineer (M.E.)  
Chartered Engineer  
Reg. No. - AM 686291-5  
Dum Dum Municipality

**SIGNATURE OF OWNERS:**

*(Signature)*

**SIGNATURE OF ENGINEER:**

*(Signature)*

**SIGNATURE OF ARCHITECT:**

*(Signature)*

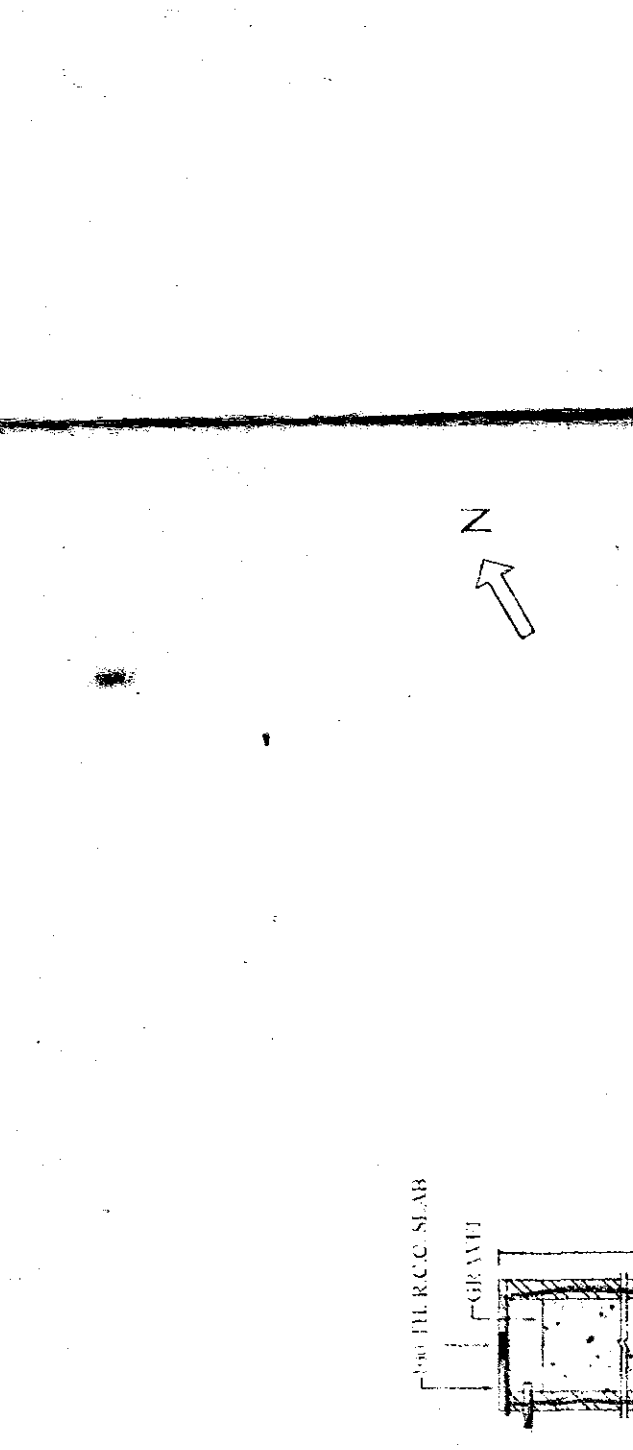
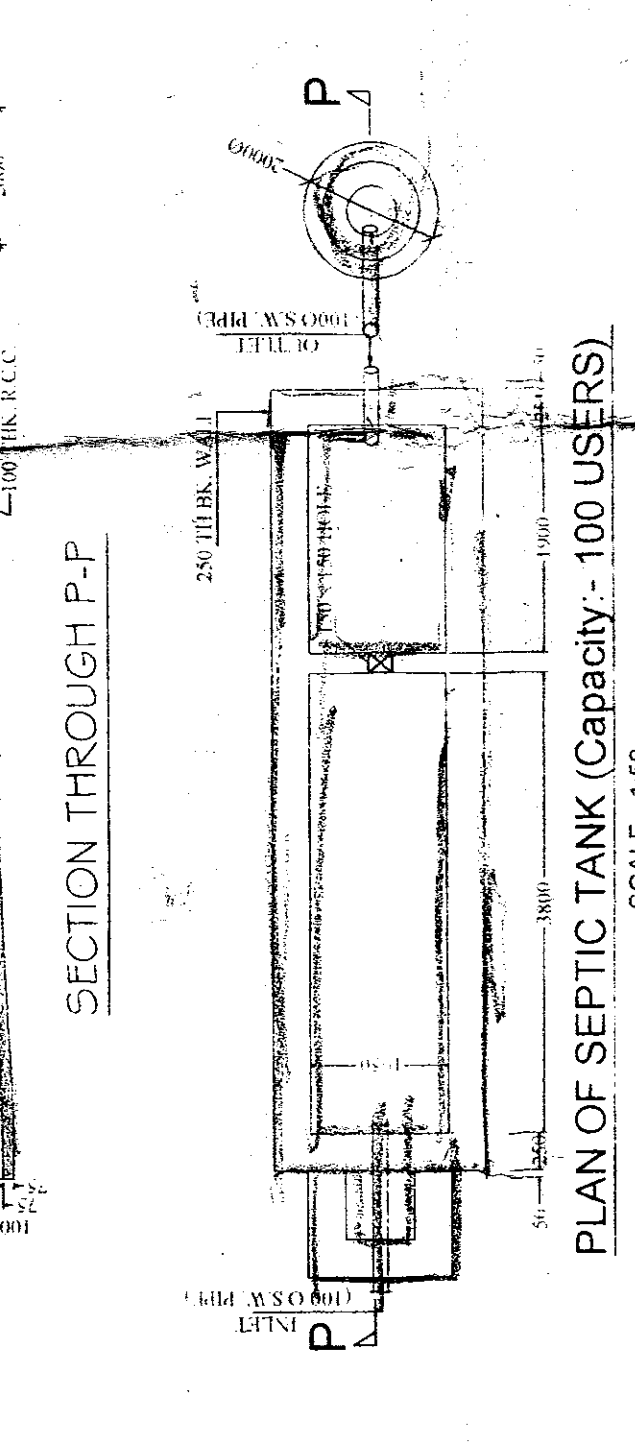
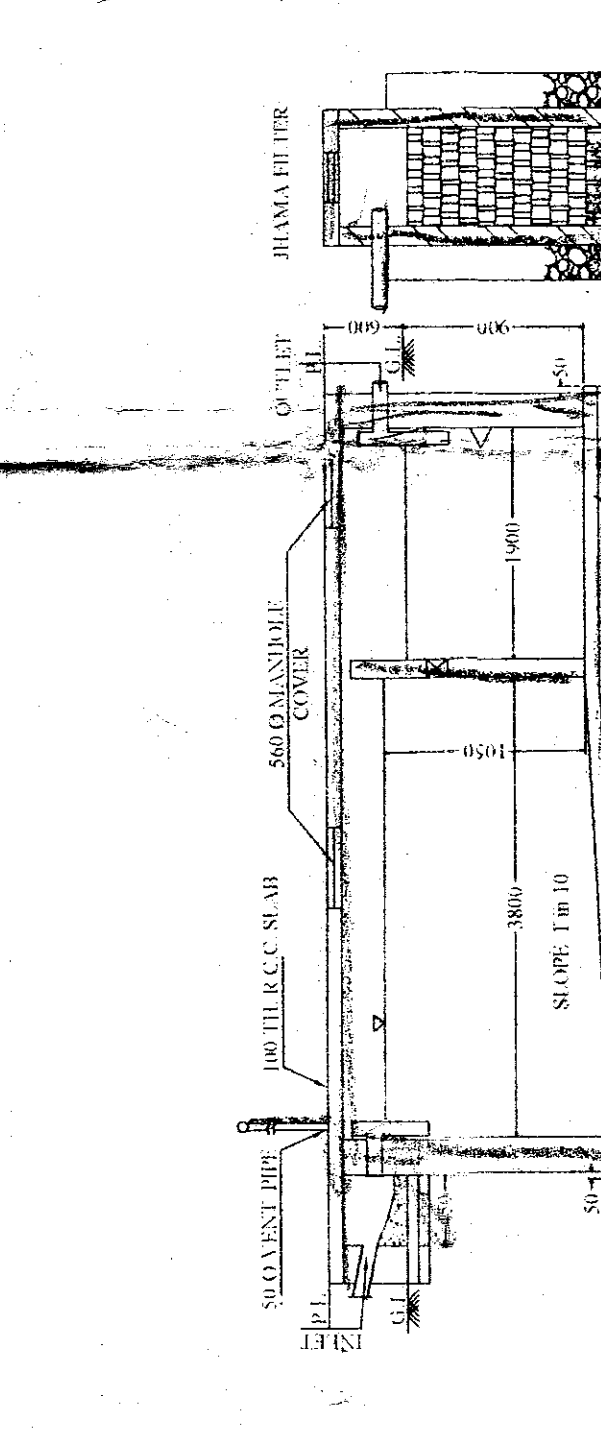

**DOORS & WINDOWS SCHEDULE**

| MKD | SIZE        | TYPE     |
|-----|-------------|----------|
| D1  | 1050 x 2100 | PANELLED |
| D2  | 900 x 2100  | PANELLED |
| D3  | 750 x 2100  | PANELLED |
| W1  | 1500 x 1350 | GLAZED   |
| W2  | 900 x 1200  | GLAZED   |
| W3  | 600 x 600   | GLAZED   |

**SPECIFICATIONS:**

1. ALL 8" x 8" PARTITION BRICKS SHALL BE 1:5 CEMENT MORTAR.
2. 300 HIGHS AND 150 WALLS SHALL BE 1:4 CEMENT MORTAR.
3. CHILING AND ALL FLOOR PLASTER SHALL BE 1:3 CEMENT MORTAR.
4. 25 MM THICK WOODEN FLOORING.

